

Contents

Calculation of the leaf dimensions	19
Components	20
1 Guide on the floor	22
2 Guide over angle bracket on facade	24
3 Guide over profile on facade	27
4 Guide over profile in the floor	30
5 Guide for glass elements	31

Calculation of the leaf dimensions

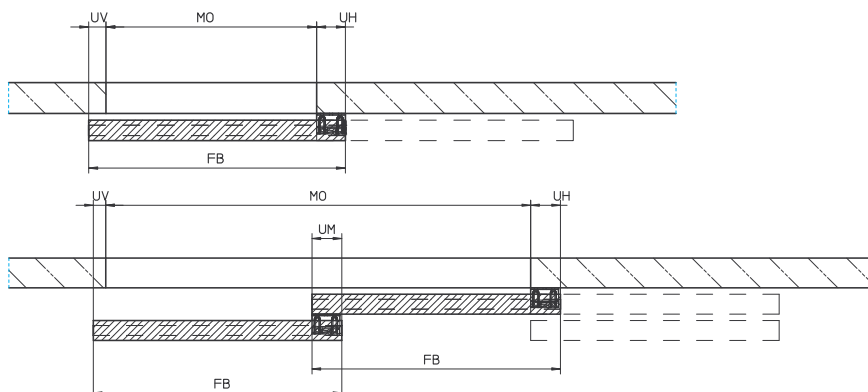

Calculation of guide profile

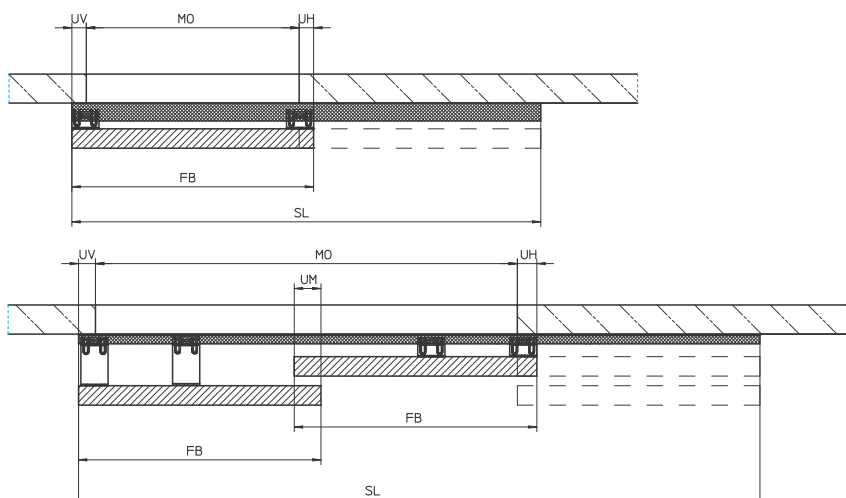

FB = leaf width
 SL = length of the guide profile
 MO = wall opening
 UV = front cover
 UM = middle cover
 UH = back cover

Calculation of the leaf dimensions:

- Single-leaf: $LW = WO + FC + BC$
- Two-leaf, running face to face: $LW = (WO + FC + MC + BC) / 2$

Calculation of the length of the guide profile:

- Single-leaf: $LG = LW \times 2 - BC$
 - Two-leaf, running face to face: $LG = LW \times 3 - MC - BC$
- Alternative: $WO + LW + FC$

COMPONENTS

ADJUSTABLE GUIDE
Ident-No.: 123514

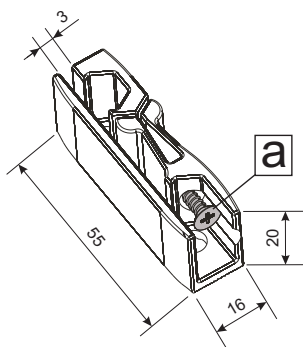

ANGLE BRACKET

ANGLE BRACKET - 40 mm
Ident-No.: 123511

ANGLE BRACKET - 60 mm
Ident-No.: 123512

ANGLE BRACKET - 100 mm
Ident-No.: 123513

! For every angle bracket, 1 piece of adjustable guide is necessary!

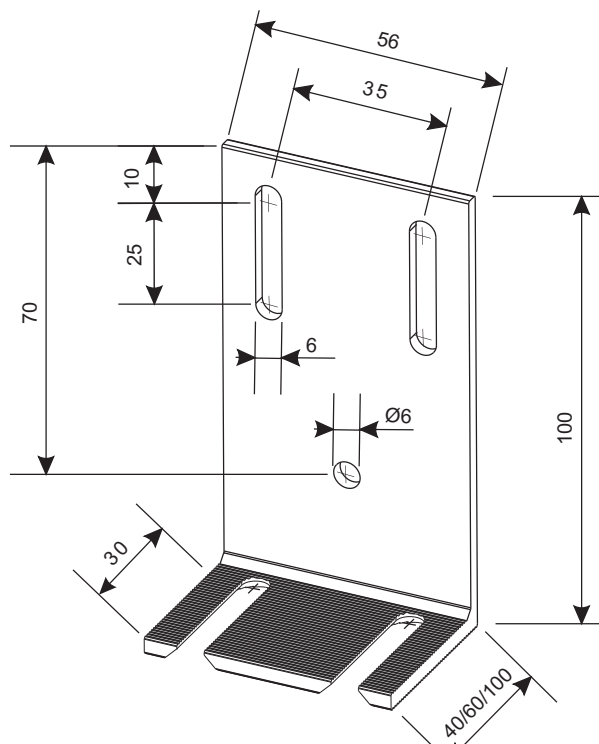

Guide rails

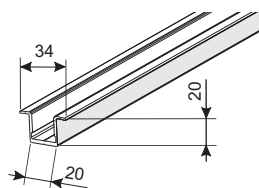

OMEGA FLOOR GUIDE PROFILE
(Length = 6M)
Ident-No.: 124640

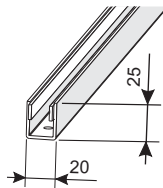

CONTINUOUS FLOOR GUIDE PROFILE
STAINLESS STEEL CONFIGURABLE
(Length ≤ 3M) / Ident-No.: 124662

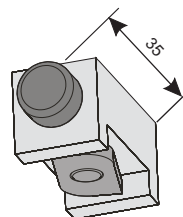

INRAIL FLOOR GUIDE BUFFER
Ident-No.: 124655

Profile

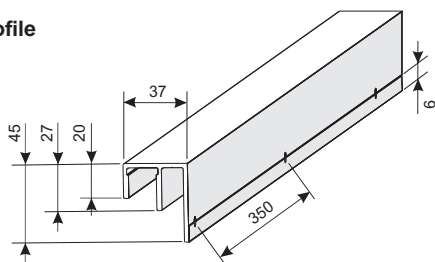

GUIDE PROFILE M-FORM (Length = 6M)
Ident-No.: 124661

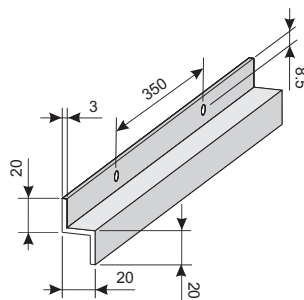

GUIDE PROFILE Z-FORM (Length = 6M)
Provided by customer

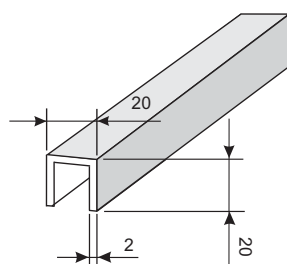

ALUMINIUM U PROFILE 20/20/2 mm
Provided by customer

1 GUIDE ON THE FLOOR

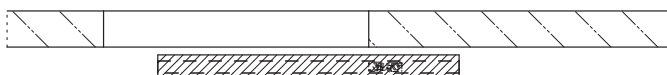

Guide U profile in the leaf / Guide on the floor
for single-leaf sliding doors for interior application, with free passage

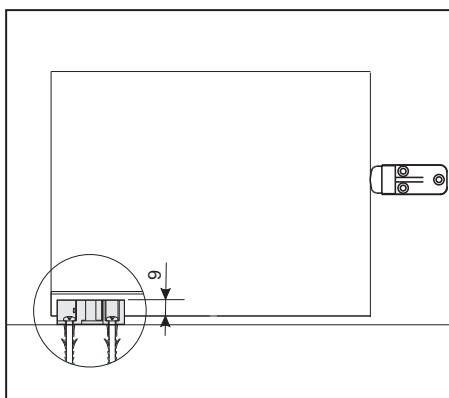

Rebate the bottom edge of the sliding leaf in the centre for the Omega floor Guide profile or an aluminium U profile 20/20/2 mm and fix profile on the entire length.

Alternatively the adjustable guide can also be directly inserted in the grooving with 16 mm width.

Fix the adjustable guide on the floor. Thereby this should be positioned in such a way that the sliding leaf is exactly vertically suspended and guided in any position.

Suspend the door leaf in suspension bolts according to instructions and adjust the height so that at least 9 mm of the adjustable guide is inserted in the guide profile.

Adjust the bottom guide to the guide profile using the frontal screw [a].

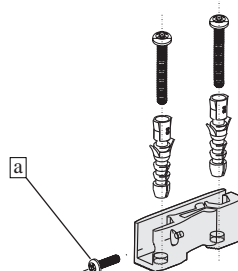
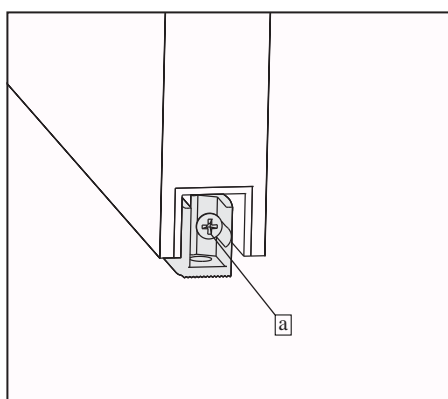

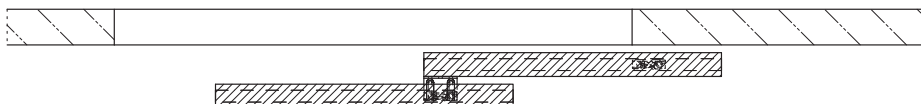

Rebate the bottom edges of the sliding leaf in the centre for an aluminium U profile 20/20/2 mm.

**Guide U profile in the leaf /
guide on floor and on angle bracket**
for two-leaf sliding doors for interior
application, with free passage

Router 8mm from the outer face of the leading door leaf and fix the U-profile as in drawing.

Alternatively the adjustable guides can also be directly inserted in a grooving with 16 mm width.

Fix the adjustable guide for the back sliding leaf on the floor. Thereby this is positioned in such a way that the sliding leaf is exactly vertically suspended and is guided in any position.

Mount the angle bracket 40 mm in the closing direction on the back sliding leaf as far as possible towards the front.

Suspend both door leaves on suspension bolts according to instructions and make adjustments so that the adjustable guide is inserted at least 9 mm in the guide profile of the back sliding leaf.

Adjust the height of the angle bracket by means of the long slots so that the adjustable guide is inserted at least 9 mm in the guide profile of the front sliding door.

Position the adjustable guide on the angle bracket in such a way that the front sliding leaf is also exactly vertically suspended.

Adjust the bottom guide to the guide profile using the frontal screws [a].

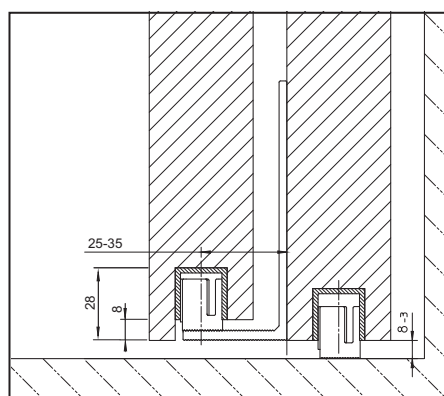
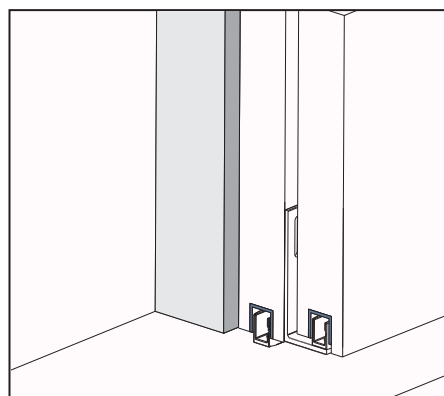

2 GUIDE OVER ANGLE BRACKET ON FACADE



Guide profile, in or at the leaf, angle bracket with adjustable guide on the facade
for narrow single-leaf sliding shutters, without visible guide profiles

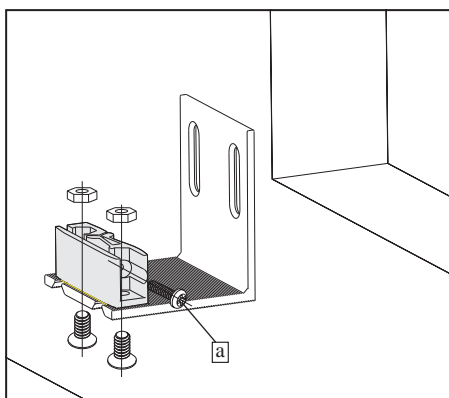

If the lower guide cannot be mounted on the floor, an angle bracket can be mounted on the facade as an adapter. Thereby this angle bracket is to be positioned in such a way that the sliding leaf is guided in any position.

The adjustable guide should be positioned in the fluting of the angle bracket in such a way that the sliding leaf is exactly vertically suspended. Hexagonal nuts are inserted to mount the adjustable guides on angle brackets.

According to the clearance between the sliding leaf and the facade, different angle brackets with depths of 40 mm, 60 mm or 100 mm are used. In the diagrams the application range for the 40 mm angle bracket is shown – for the larger angle brackets the clearance is correspondingly increased by 20 mm and 60 mm.

Set up the guide on the sliding leaf.
The following options can be used as guide profiles on the sliding leaf:

- M guide profile behind the door leaf, without visible guide profile, in case the sliding leaf cannot be rebated.

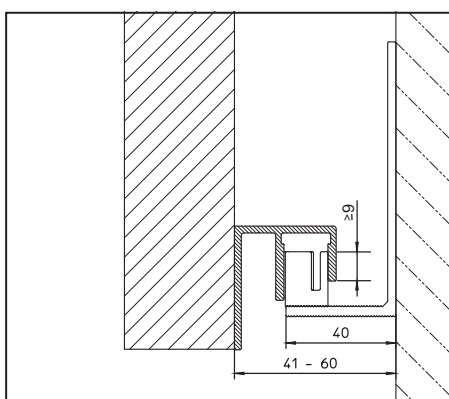

- M guide profile under the door leaf, in case the sliding leaf cannot be rebated.

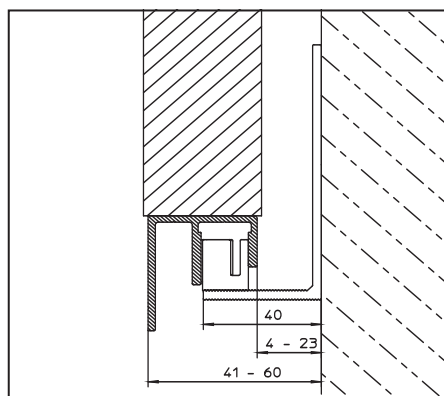

- Omega floor guide profile or aluminium U profile 20/20/2 mm notched to the lower edge of the sliding leaf. Alternatively the adjustable guide can also be directly inserted in 16 mm wide grooving.

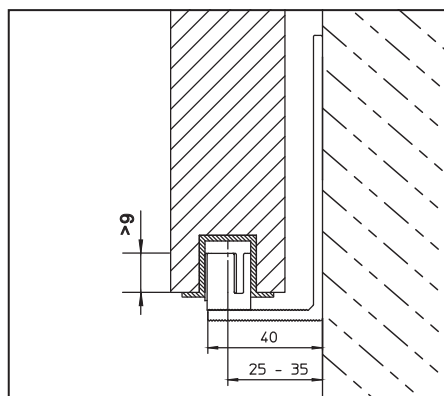

- aluminium L Profil (e.g. 20/20/3 mm provided by customer) screwed to the lower edge of the sliding leaf, for very thin, sliding leaf running close to the facade.

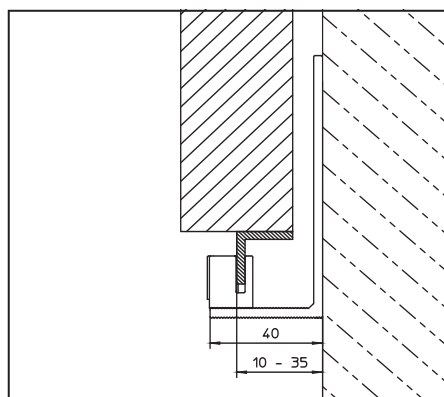

Suspend the door leaf on suspension bolts according to instructions and adjust the height. Adjust the height of the angle bracket using the long slots so that the plastic guide is inserted at least 9 mm in the guide profile.

Adjust the bottom guide to the guide profile using the frontal screws [a].

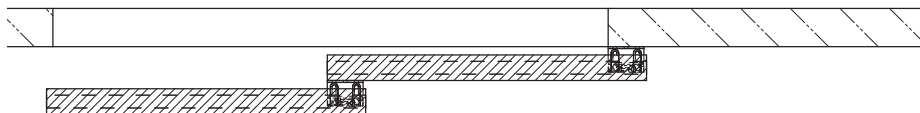

Guide profile, in or at the leaf, angle bracket with adjustable guide on the facade and on the back leaf

for thin two-leaf sliding shutters, without visible guide

If the lower guide cannot be mounted on the floor, angle brackets can be mounted on the facade as an adapter. Thereby the angle brackets have to be positioned on the facade in such a way that the back sliding leaf is guided in any position.

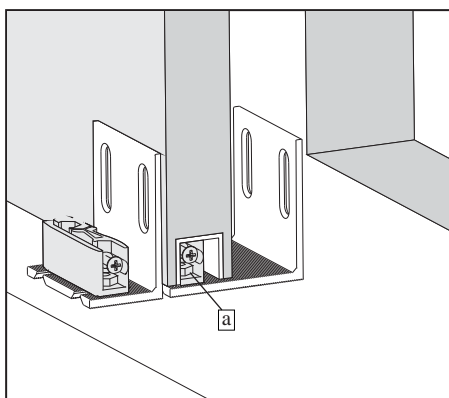

Mount the second angle bracket on the back sliding leaf as far as possible towards the front, so that the lower edge of the angle bracket lies about 10 mm below the leaf's lower edge.

Position the adjustable guides on the fluting of the angle in such a way that the sliding leaf is exactly vertically suspended. Following options can be used as guide profiles on the sliding leaf:

- Omega guide profile or U-profile notched on the lower edge of the sliding leaf. Alternatively, directly in the grooving with 16 mm width.
- M guide profile under the door leaf, in case the sliding leaf cannot be rebated.
- Aluminium L-profile (e.g. 20/20/3 mm) screwed to the lower edge of the sliding leaf, for very thin sliding leaves running close to the facade.

Suspend the door leaf on the suspension bolts according to instructions and adjust height.

Position the angle bracket using the long slots, ensuring that min. 9 mm of the adjustable guide is inserted in the guide profile.

Adjust the bottom guide to the guide profile using the frontal screws [a].

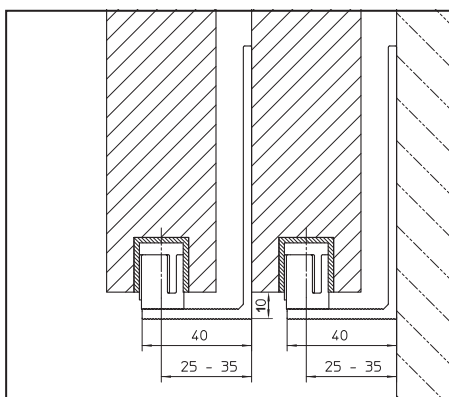

3 GUIDE OVER PROFILE ON FACADE

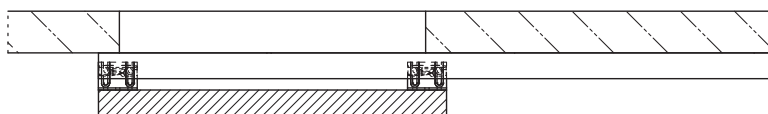

**Guide profile on the facade /
angle brackets with adjustable guide on the leaf**
Twist-proof guide for single-leaf sliding shutters

Mount two angle brackets on the lower inner side of the sliding leaf, as far as possible towards the outer edges.

Suspend door leaf on the suspension bolts according to instructions and adjust the height.

Install M guide profile or Z guide profile and mount exactly perpendicular to the facade.

The adjustable guide should be positioned in the fluting of the angle bracket in such a way that the sliding leaf is exactly vertically suspended. Hexagonal nuts are inserted to mount the adjustable guides on angle brackets.

Position the angle bracket using the long slots, ensuring that min. 9 mm of the adjustable guide is inserted in the guide profile.

Adjust the bottom guide to the guide profile using the frontal screw [a].

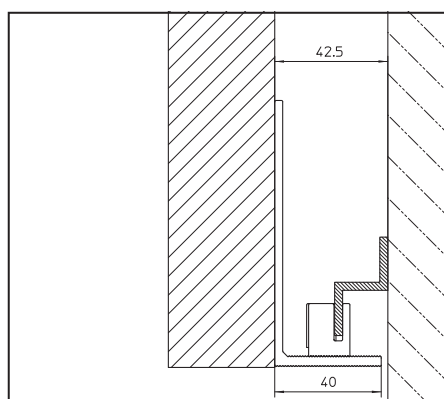
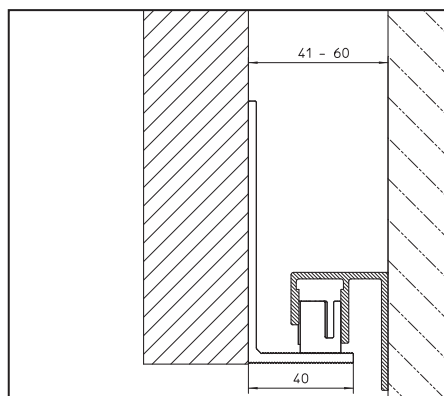

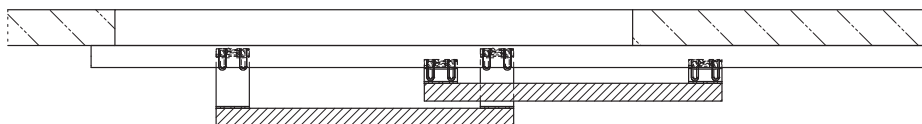

**M guide profile on the facade / angle brackets
with adjustable guide on the leaves**

Twist-proof guide for two-leaf sliding shutters

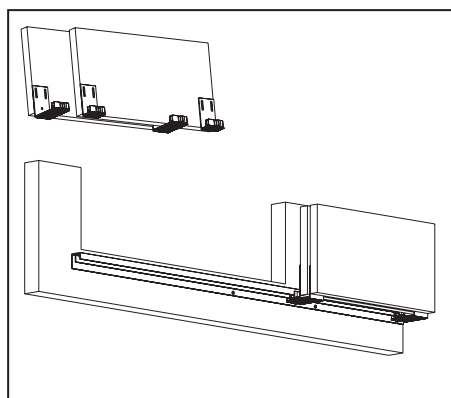

Mount two angle brackets on the back sliding leaf 40 mm and the front sliding leaf 100 mm on the lower inner side respectively, as far as possible towards the outer edge.

Thereby the angle bracket on the front leaf is positioned 7 mm lower than in the back sliding leaf.

Suspend both door leaves on the suspension bolts according to instructions and adjust the heights.

Set up M guide profile and mount exactly perpendicular to the facade.

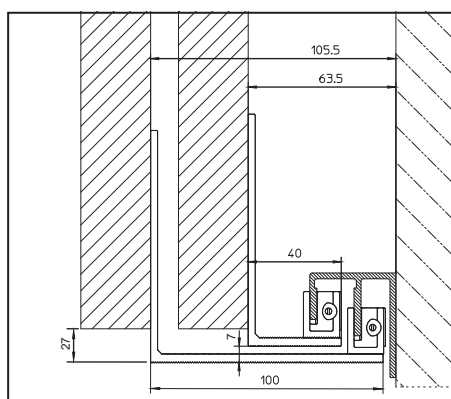

The adjustable guide should be positioned in the fluting of the angle bracket in such a way that the sliding leaf is exactly vertically suspended. Hexagonal nuts are inserted to mount the adjustable guides on angle brackets.

Position the angle bracket using the long slots, ensuring that min. 9 mm of the adjustable guide is inserted in the guide profile.

Adjust the bottom guide to the guide profile using the frontal screws [a].

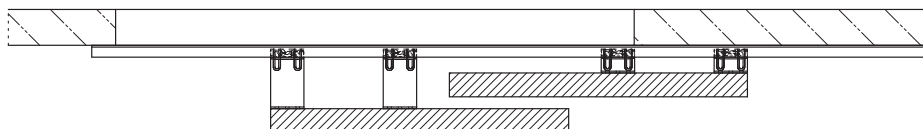

**Guide profile on the facade / angle brackets
with adjustable guide on the leaves**
Twist-proof guide for two-leaf sliding shutters

Mount two angle brackets on the back sliding leaf 40 mm and the front sliding leaf 100 mm on the lower inner side respectively.

Mount the angle brackets on the different door leaves in such a way that they do not hinder each other while running in a common guide profile.

Suspend both door leaves on the suspension bolts according to instructions and adjust heights.

Install M guide profile or Z guide profile and mount exactly perpendicular to the facade.

The adjustable guide should be positioned in the fluting of the angle bracket in such a way that the sliding leaf is exactly vertically suspended. Hexagonal nuts are inserted to mount the adjustable guides on angle brackets.

Position the angle bracket using the long slots, ensuring that min. 9 mm of the adjustable guide is inserted in the guide profile.

Adjust the bottom guide to the guide profile using the frontal screws [a].

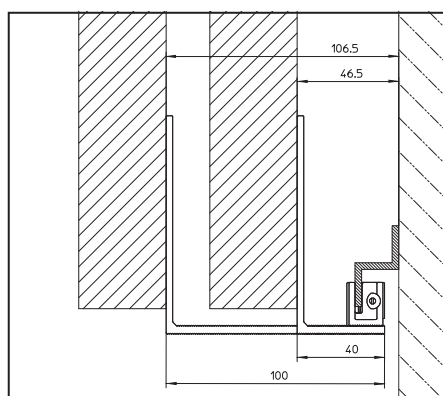
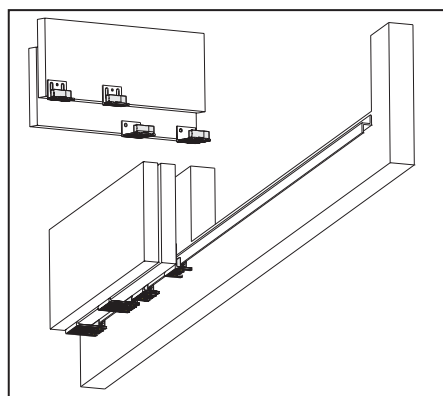

4 GUIDE OVER PROFILE IN THE FLOOR



**Continuous guide profile in the floor /
Guide on the leaf**
Twist-proof guide for single-leaf sliding doors

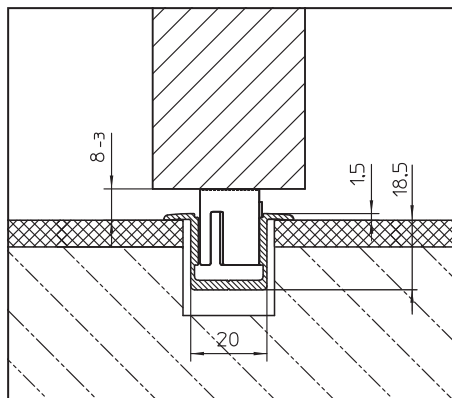
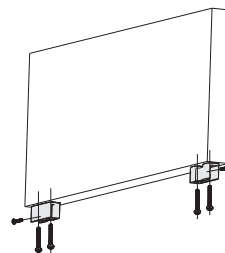

Cut out floor for floor guide profile and fix or glue the bottom guide profile in the groove.

Fasten the adjustable guide on the bottom side of the leaf as far as possible towards the outer edge. In case the buffer is used for the bottom guide profile, keep an edge distance of 40 mm.

Insert the door leaf with the adjustable guides in the guide profile, suspend on the suspension bolts and adjust the height so that min. 9 mm of the adjustable guide is inserted in the guide profile.

Adjust the bottom guide to the guide profile using the frontal screw [a].

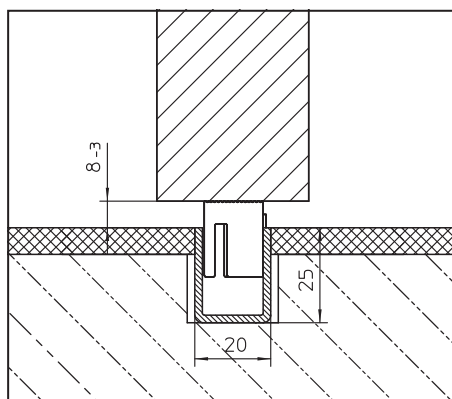

If need be, insert and fix the inrail floor guide buffer in the required position in the rail.

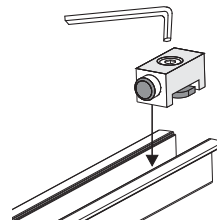

5 GUIDE FOR GLASS ELEMENTS

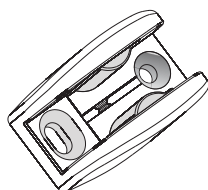

ADJUSTABLE GLASS FLOOR GUIDE
Ident-No.: 120417

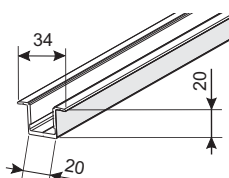
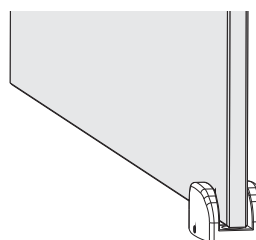

GLAS GUIDE PROFILE FOR 8MM (Length= 6M) Ident-No.: 124651
GLAS GUIDE PROFILE FOR 10MM (Length= 6M) Ident-No.: 124652
GLAS GUIDE PROFILE FOR 12MM (Length= 6M) Ident-No.: 124653

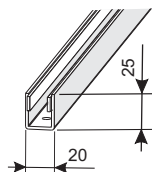
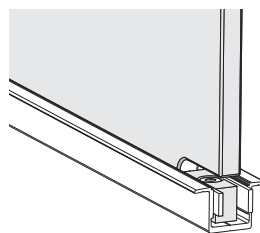

CONTINUOUS BOTTOM GUIDE STAINLESS STEEL CONFIGURABLE.
(Length ≤ 3M) / Ident-No.: 124662

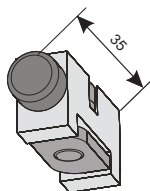
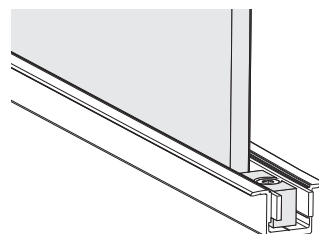

INRAIL GLASS GUIDE BUFFER
Ident-No.: 124656

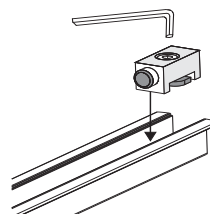

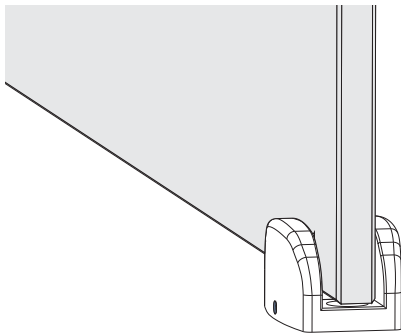

Adjustable glass guide

for full glass sliding doors for interior application, with free passage

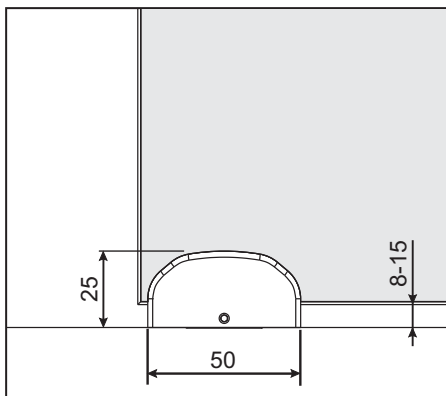

Plug in the black guiding jaws from below on the base of the adjustable glass floor guide.

Fix the adjustable glass floor guide on the floor. Thereby position this in such a way that the sliding leaf is exactly vertically suspended and is guided in any position.

Suspend door leaf on suspension bolts according to instructions and adjust the height in such a way that at least 9 mm of the glass pane is inserted in the adjustable glass floor guide.

Align the guiding jaws to the thickness of the pane using the side screws. Thereby the perpendicular position of the leaf can also be corrected.

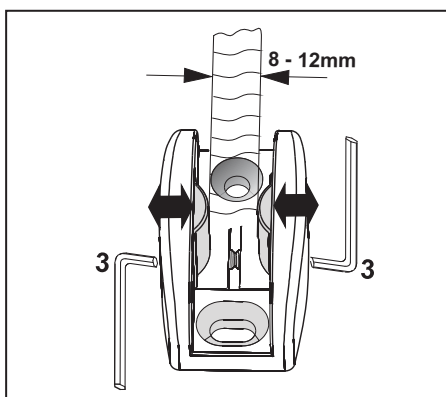

Glass guide profile with felt sliding surfaces in the floor

Twist-proof guide for full glass sliding doors.

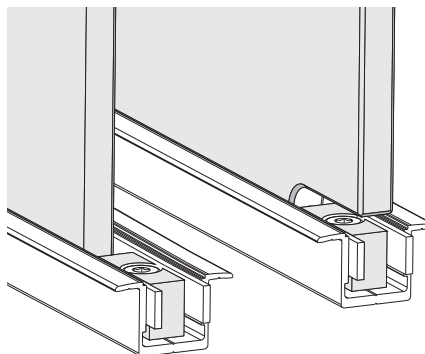

Cut out the floor for guide profile and fix or glue the glass guide profile in the groove.

Insert door leaf in the guide profile, suspend on suspension bolts and adjust the height in such a way that at least 9 mm of the pane is inserted in the guide profile.

If need be, insert and fix the inrail glass guide buffer in the required position in the rail.

In case the glass pane is flush with the guide profile while using the buffer, then a marginal section of 40 x 15 mm is required in the glass.

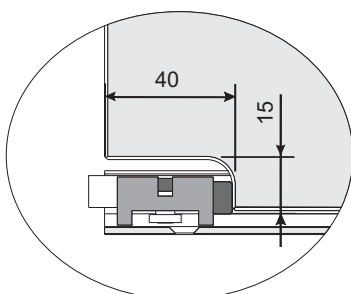
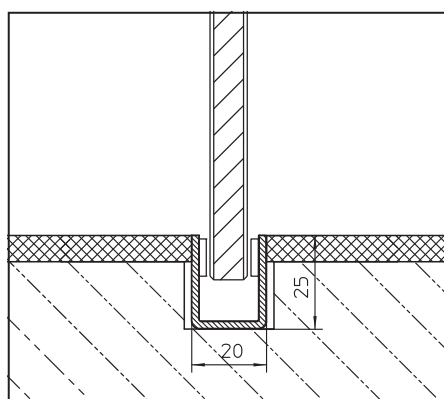
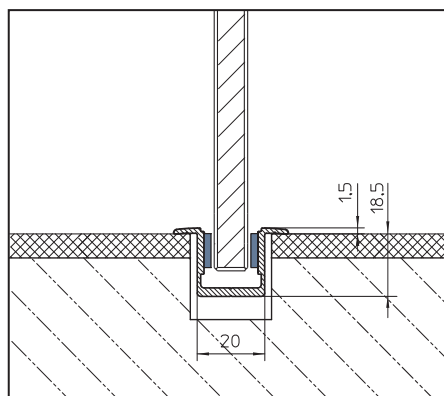



GEZE

GEZE



GEZE GmbH
P.O. Box 1363
71226 Leonberg
Germany

GEZE GmbH
Reinhold-Vöster-Str. 21-29
71229 Leonberg
Germany
Tel. +49 (0) 71 52-203-0
Fax +49 (0) 71 52-203-310

GEZE Online:
www.geze.com

GEZE Niederlassungen

Deutschland

GEZE GmbH
Niederlassung Nord/Ost
Bühningstr.8
13086 Berlin (Weissensee)
Tel. +49(0)30-47 89 90-0
Fax. +49(0)30-47 89 90-17
E-Mail: berlin.de@geze.com

GEZE GmbH
Niederlassung West
Nordsternstraße 65
45329 Essen
Tel. +49(0)201-830 82-0
Fax. +49(0)201-830 82-20
E-Mail: essen.de@geze.com

GEZE GmbH
Niederlassung Mitte
Adenauerallee 2
61440 Oberursel (b. Frankfurt)
Tel. +49(0)61 71-6 36 10-0
Fax. +49(0)61 71-6 36 10-1
E-Mail: frankfurt.de@geze.com

GEZE GmbH
Niederlassung Süd
Reinhold-Vöster-Straße 21-29
71229 Leonberg
Tel. +49(0)7152-203-594
Fax. +49(0)7152-203-438
E-Mail: leonberg.de@geze.com

Tochtergesellschaften

Deutschland

GEZE Sonderkonstruktionen GmbH
Planken 1
97944 Boxberg-Schweigern
Tel. +49(0)7930-9 2 94-0
Fax. +49(0)7930-9 2 94-10
E-Mail: sk.de@geze.com

GEZE SERVICE GmbH
Reinhold-Vöster-Str.25
71229 Leonberg
Tel. +49(0)7152-92 33-0
Fax. +49(0)7152-92 33-60
E-Mail: info@geze-service.com

GEZE SERVICE GmbH
Niederlassung Berlin
Bühningstr.8
13086 Berlin (Weissensee)
Tel. +49(0)30-47 02 17-30
Fax. +49(0)30-47 02 17-33

Asien

GEZE Industries (Tianjin) Co., Ltd.
Shuangchenzhong Road
Beichen Economic Development Area (BEDA)
Tianjin 300400, P.R. China
Tel. +86 (0) 22-26 97 39 95-0
Fax. +86 (0) 22-26 97 27 02
E-Mail: geze@public1.tpt.tj.cn

GEZE Industries (Tianjin) Co., Ltd.
Branch Office Shanghai
Room 3010
Tower 2, Grand Gateway
No. 3 HongQiao Road, XuHui District
200030 Shanghai, P.R. China
Tel. +86 (0) 21 64475908
Tel. +86 (0) 21 64479968
Fax. +86 (0) 21 64472007
E-Mail: gezesh@geze.com.cn

GEZE Industries (Tianjin) Co., Ltd.
Branch Office Guangzhou
Room 17C3 Everbright Bank Building,
No.689,
Tian He Bei Road
510630 Guangzhou, P.R. China
Tel. +86 (0) 20 3873842
Tel. +86 (0) 20 81320702
Fax. +86 (0) 20 38731834
E-Mail: gezegz@geze.com.cn

GEZE Industries (Tianjin) Co., Ltd.
Branch Office Beijing
No. 6-32 Building
Jili Avenue
Daxing District
100076 Beijing, P.R. China
Tel. +86 (0) 10 87975177
Tel. +86 (0) 10 87975178
Fax. +86 (0) 10 87975171
E-Mail: gezebj@geze.com.cn

GEZE Asia Sales Ltd.
No. 88-1-408, East Road
Free Trade Zone of Tianjin Port
Tianjin, P.R. China
Tel. +86 (0) 22 26 97 39 95-0
Fax. +86 (0) 22 26 97 27 02
E-Mail: geze@public1.tpt.tj.cn

Südafrika

DCLSA Distributors (Pty) Ltd.
Morkels Close, Midrand
P.O. Box 7934, Midrand 1685
South Africa
Tel. ++27 11 3158286
Fax. ++27 11 31558261
E-Mail: info@dclsa.co.za

Vereinigte Arabische Emirate

GEZE Middle East
P.O. Box 17903
Jebel Ali Free Zone
Dubai, U.A.E.
Tel. +971 (0) 4 88 33 112
Fax. +971 (0) 4 88 33 240
E-Mail: geze@emirates.net.ae

Europa

Frankreich
GEZE France S.A.R.L.
ZAC de l'Orme Rond
RN 19
77170 Servon
Tel. +33 (0) 1 60 62 60 70
Fax. +33 (0) 1 60 62 60 71
E-Mail: france.fr@geze.com

Großbritannien

GEZE UK Ltd.
Blenheim Way
Fradley Park, Fradley
Lichfield
Staffordshire WS13 8SY
Tel. +44 (0) 15 43 44 30 00
Fax. +44 (0) 15 43-44 30 01
E-Mail: info@geze-uk.com

Italien

GEZE Italia Srl
Via Giotto 4
20040 Cambiago (MI)
Tel. +39 (0) 02 95 06 95-11
Fax. +39 (0) 02 95 06 95-33
E-Mail: italia.it@geze.it

GEZE Engineering Roma Srl
Via Lucrezia Romana 91
00178 Roma
Tel. +39 (0) 06 72 65 31 1
Fax. +39 (0) 06 72 65 31 36
E-Mail: gezeroma@libero.it

GEZE Engineering Bari Srl
Via Treviso 58
70022 Altamura (Bari)
Tel. +39 (0) 080 31 15 21 9
Fax. +39 (0) 080 31 64 56 1
E-Mail: gezebari@libero.it

Benelux

GEZE Benelux B.V.
Industrieterrein Kapelbeemd
Leemkuil 1
5626 EA Eindhoven
Tel. +31 (0) 40 26 29 08 0
Fax. +31 (0) 40 26 29 08 5
E-Mail: benelux.nl@geze.com

Österreich

GEZE Austria GmbH
Mayrwiesstraße 12
5300 Hallwang b. Salzburg
Tel. +43 (0) 662 66 31 42
Fax. +43 (0) 662 66 31 42-15
E-Mail: austria.at@geze.com

Polen

GEZE Polska Sp. z o.o.
ul. Annopol 3 (Zerań Park)
03-236 Warszawa
Tel. +48 (0) 22 814 22 11
Fax. +48 (0) 22 814 25 40
E-Mail: geze@geze.pl

Schweiz

GEZE Schweiz AG
Bodenackerstr. 79
4657 Dulliken
Tel. +41 (0) 62-285 54 00
Fax. +41 (0) 62-285 54 01
E-Mail: schweiz.ch@geze.com

Spanien / Portugal

GEZE Iberia S.R.L.
Rl. Del Pla
C/Comerc, 2-22, Nave 12
08980 Sant Feliu de Llobregat
(Barcelona)
Tel. +34 (0) 9 02 19 40 36
Fax. +34 (0) 9 02 19 40 35
E-Mail: iberia.es@geze.com

Skandinavien

Schweden

GEZE Scandinavia AB
Mallslingan 10
Box 7060
18711 Täby
Tel. +46 (0) 8-732 34-00
Fax. +46 (0) 8-732 34-99
E-Mail: sverige.se@geze.com

Norwegen

GEZE Scandinavia AB avd. Norge
Postboks 63
2081 Eidsvoll
Tel. +47 (0) 639 572 00
Fax. +47 (0) 639 571 73
E-Mail: norge.se@geze.com

Finnland

GEZE Finland
Branch office of GEZE Scandinavia AB
Postbox 20
Herralantie 824
15871 Hollola
Tel. +358 (0) 10-400 5100
Fax. +358 (0) 10-400 5120

Dänemark

GEZE Denmark
Branch office of GEZE Scandinavia AB
Højte Taastrup Boulevard 53
DK-2630 Taastrup
Tel. +45 46-32 33 24
Fax. +45 46-32 33 26
E-Mail: denmark.se@geze.com

Gemäß der im Produkthaftungsgesetz definierten Haftung des Herstellers für seine Produkte sind die in dieser Broschüre enthaltenen Informationen (Produktinformationen und bestimmungsgemäße Verwendung, Fehlergebrauch, Produktleistung, Produktwartung, Informations- und Instruktionspflichten) zu beachten. Die Nichtbeachtung entbindet den Hersteller von seiner Haftungspflicht.

GEZE Repräsentant:

