

GEZE Perlan 140 concealed wall bracket

In order to achieve wall installation without on-site cover, installation must be as inconspicuous as possible. For this purpose, GEZE has developed a concealed wall bracket which, when combined with the glass clamping plate or the concealed carrier plate, offers minimum design space for a sliding door. The bracket is available in two different distances: for glass doors which are flush to the wall and for wooden doors with a larger distance to the wall (11 mm). The wooden door variant is also suitable for external applications. As required, the wall can be protected from water stains using sealing rubber. For all variants, GEZE supplies an end cover which can either be glued in place (internal application) or screwed in place (external application). The brackets and distance profiles are available in all track lengths as standard. Also in the standard length 6000 mm or cut to size.

GEZE Perlan 140, concealed wall bracket

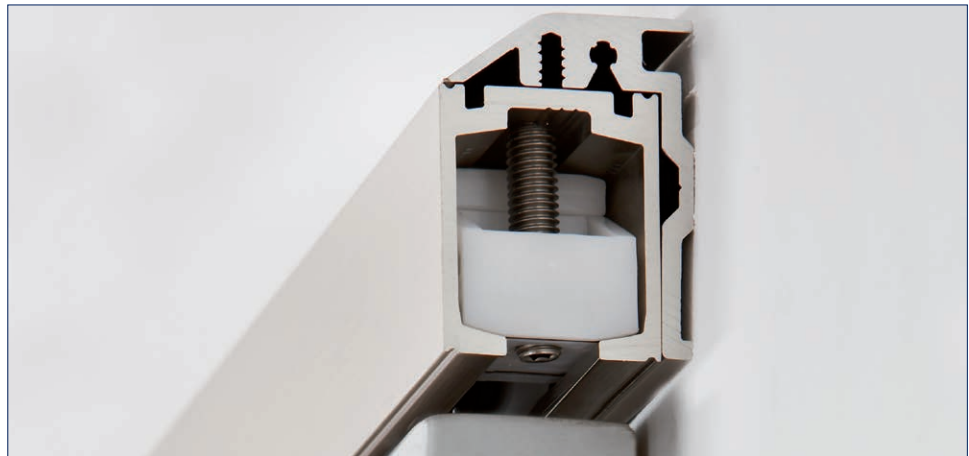

Continuous angle (e.g. glass leaf)

Application range

- For wood, plastic, glass and metal leaves up to 140 kg leaf weight
- For wall assembly within the visible area
- Mounting above a door frame or wall tiles

Technical data

Product features	GEZE Perlan 140, concealed wall bracket
Door material	Wood, Plastic, Metal, Glass, Sliding shutters
Number of leaves	1-leaf, 2-leaf
Type of installation	Wall installation
Automated	•
Draw-in damping	•

• = YES

GEZE Perlan 140 concealed wall bracket with wooden leaf

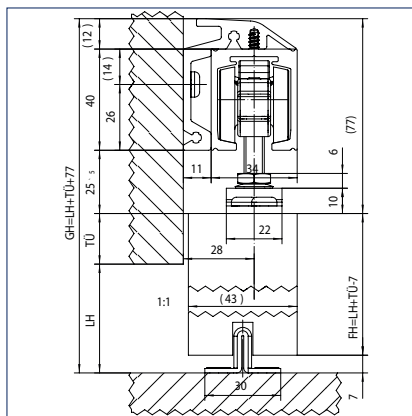
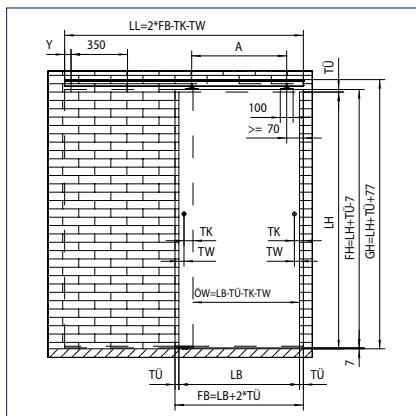

LL = Track length
 FB = Leaf width
 TK = Distance door handle to edge of leaf
 TW = Distance door handle to wall
 Y = Distance to first drill hole
 A = Distance between suspension bolts
 TÜ = Door clearance
 LH = Clear height
 LB = Clear width
 GH = Total height
 FH = Leaf height
 ÖW = Opening width
 SH = Panel height

GEZE Perlan 140 concealed wall bracket with glass leaf and glass clamping plate 30 mm

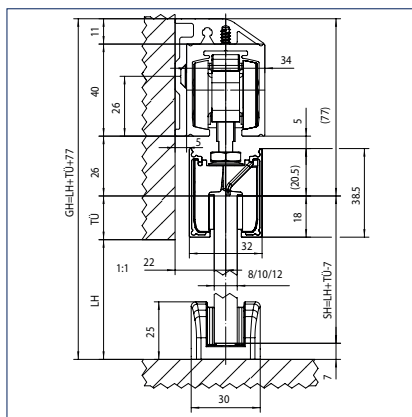
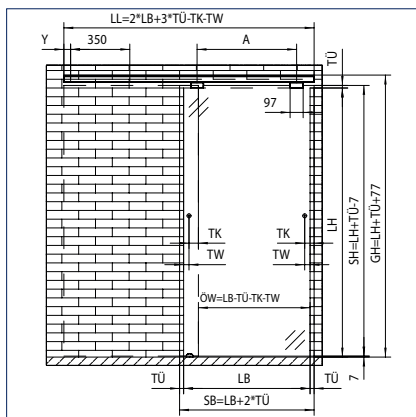

GEZE Perlan 140 concealed wall bracket with glass leaf and glass clamping plate 40 mm

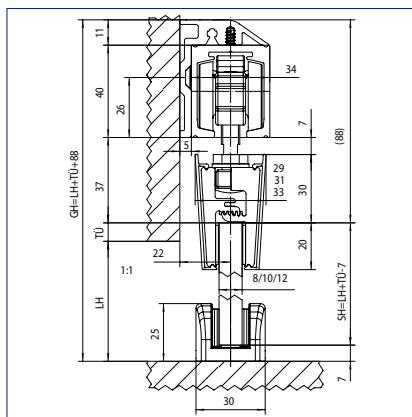
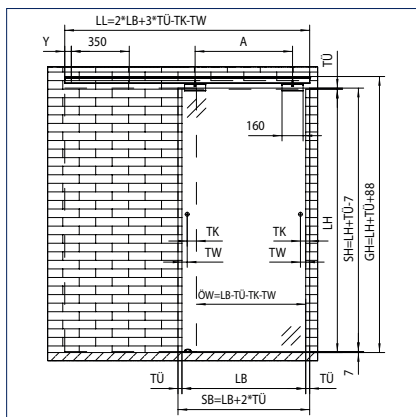

GEZE Perlan 140, concealed wall bracket - Order information

Description	Length	Version	ID.No.
Wall bracket, concealed, Perlan for use up to 37 mm leaf thickness	1650 mm	EV1	130419
	2050 mm	EV1	130418
	2450 mm	EV1	130417
	3250 mm	EV1	130415
	6000 mm	EV1	130414
	1650 mm	stainless steel colour	130466
	2050 mm	stainless steel colour	130465
	2450 mm	stainless steel colour	130464
	6000 mm	stainless steel colour	130463
		EV1	130462
Wall bracket, concealed, Perlan bespoke, for use up to 37 mm leaf thickness		stainless steel colour	130468
Wall bracket, concealed, Perlan for use up to 43 mm leaf thickness	1650 mm	EV1	130440
	2050 mm	EV1	130439
	2450 mm	EV1	130438
	3250 mm	EV1	130436
	6000 mm	EV1	130435
	1650 mm	stainless steel colour	130447
	2050 mm	stainless steel colour	130446
	2450 mm	stainless steel colour	130445
	6000 mm	stainless steel colour	130444
		EV1	130443
Wall bracket, concealed, Perlan bespoke, for use up to 43 mm leaf thickness		stainless steel colour	130449
Accessories			
Seal wall connection for use with Perlan „concealed wall bracket up to 43 mm“ or „Basic profile wall installation outdoors“	200000 mm	black	127311
Seal wall connection Cut to size, for use with Perlan „concealed wall bracket up to 43 mm“ or basic profile wall installation outdoors		black	127731
End cover set for concealed wall brackets up to 37 mm (2 pcs)		EV1	130432
		stainless steel colour	130433
End cover set for concealed wall brackets up to 43 mm (2 pcs)		EV1	130141
		stainless steel colour	130142
Set of countersunk screws for concealed wall bracket, Perlan 18 pcs., for fixing Perlan track (countersunk version) to concealed wall bracket			138708
Set of countersunk screws for concealed wall bracket, Perlan 100 pcs., for fixing Perlan track (countersunk version) to concealed wall bracket			132229

GEZE Perlan 140 spacer profile for concealed wall bracket

GEZE offers further spacer profiles for the concealed wood wall bracket, in order to create even more clearance from the wall. This is particularly necessary if the door is to move in front of a door frame or wall tiling. The spacer profile for the concealed wall bracket is simply screwed on the wall with the wall bracket along the length of the track and also provides an additional 10 or 20 mm clearance.

GEZE Perlan 140 spacer profile for concealed wall bracket



Application range

- For wood, plastic, glass and metal leaves up to 140 kg leaf weight
- For wall assembly within the visible area
- For mounting above a doorframe or wall tiles

Technical data

Product features	GEZE Perlan 140 spacer profile for concealed wall bracket
Door material	Wood, Plastic, Metal, Glass, Sliding shutters
Number of leaves	1-leaf, 2-leaf
Type of installation	Wall installation
Draw-in damping	•

• = YES

GEZE Perlan 140 spacer profile for concealed wall bracket - Order information

Description	Length	Version	ID.No.
Spacer profile 10 mm for concealed wall bracket Perlan 43 mm for use with „concealed wall bracket up to 43 mm“, stackable up to 20 mm space	1650 mm	EV1	136679
	2050 mm	EV1	136680
	2450 mm	EV1	136711
	6000 mm	EV1	136712
	1650 mm	stainless steel colour	136713
	2050 mm	stainless steel colour	136714
	2450 mm	stainless steel colour	136715
	6000 mm	stainless steel colour	136716
Spacer profile 10 mm for concealed wall bracket Perlan 43 mm configured to customer wishes			136717
Accessories			
Seal wall connection for use with Perlan „concealed wall bracket up to 43 mm“ or „Basic profile wall installation outdoors“	200000 mm	black	127311
Seal wall connection Made to measure, for use with Perlan „concealed wall bracket up to 43 mm“ or basic profile wall installation outdoors		black	127731
End cover set for concealed Perlan wall bracket with 10 mm spacer (2 pcs)		EV1	136732
		stainless steel colour	136733
End cover set for concealed Perlan wall bracket with 20 mm spacer (2 pcs)		EV1	136734
		stainless steel colour	136735

GEZE Perlan 140 clip-on cover 100

The clip-on cover 100 with an overall height of only 100 mm enables visually attractive covering of the fittings technology underneath it. It is easily and securely attached using plastic clips, which ensure the cover is securely held regardless of the area of use. This means any tolerances in the aluminium profiles can be evened out. Different distances from the track are possible for glass and wooden doors: in the case of glass doors the clip-on cover is clipped directly into the track, in the case of wooden doors via additional spacer brackets, which are screwed onto the track. With the clip-on cover, GEZE has managed to keep the gap in glass doors visible from underneath as small as possible and yet nevertheless be able to use the same product for thick wooden doors, too.

GEZE Perlan 140 clip-on cover 100



Application range

- For covering the GEZE Perlan 140 and Rollan 40 N / 80 sliding fittings
- For wall and ceiling installation
- For internal application
- For wood, plastic, glass and metal leaves up to 140 kg leaf weight

Technical data

Product features	GEZE Perlan 140 clip-on cover 100
Door material	Wood, Plastic, Metal, Glass
Type of installation	Wall installation, Ceiling installation
Telescope	•
Automated	•
Fixed panel	•
Draw-in damping	•

• = YES

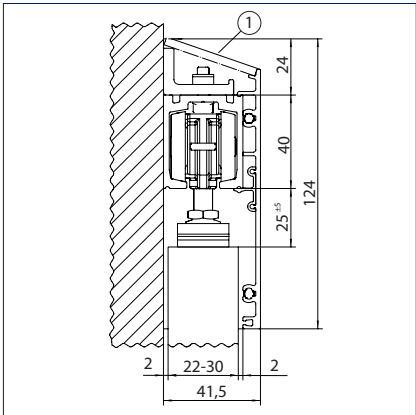

Clip-on cover wall installation, wooden leaf 22-30 mm
1 = Cover (optional) on-site recommendation 41x3

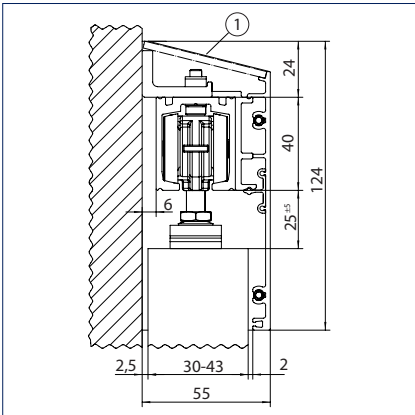

Clip-on cover wall installation, wooden leaf 30-43 mm
1 = Cover (optional) on-site recommendation 54x3

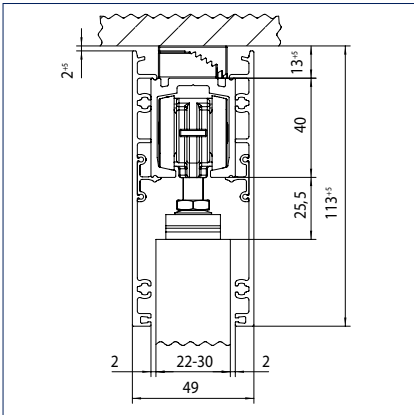

Clip-on cover ceiling installation, wooden leaf 22-30 mm



Ceiling compensation set/ceiling spacer, stepless

GEZE Perlan 140 clip-on cover 100 - Order information

Description	Length	Version	ID.No.
Complete clip-on cover set 100 for wall and ceiling mounting, continuous cover, configured according to customer wishes			138098
Accessories			
Clip-on cover 100 profile for wall and ceiling mounting, continuous cover	1650 mm	EV1	137602
	2050 mm	EV1	137603
	2450 mm	EV1	137604
	6230 mm	EV1	137606
	1650 mm	stainless steel colour	137608
	2050 mm	stainless steel colour	137609
	2450 mm	stainless steel colour	137611
	6060 mm	stainless steel colour	137613
Clip-on cover 100 profile for wall and ceiling mounting, continuous cover, bespoke, choice of finishes			137614
Set of end covers clip-on cover 100 2 pcs., narrow version, for use without spacer bracket		EV1	137865
		stainless steel colour	137867
		acc. to RAL	137869
Set of end covers clip-on cover 100 2 pcs., wide version, for use with spacer bracket		EV1	137864
		stainless steel colour	137866
		acc. to RAL	137868
Clip-on cover set 100 spacer bracket 6 pcs., enlarges the distance at the side of the clip-on cover by 7.5 mm at each side. For use with Perlan AUT NT as well as for leaf thicknesses from 30 mm			137754
Clip-on cover set 100 plastic clip 10 pcs., for the direct attachment of the clip-on cover 100 on the track or the spacer brackets			137863
Ceiling compensation set/ceiling spacer, stepless 6 pcs., continuously variable height compensation from 13 mm to 18 mm. For ceiling mounting using clip-on cover 100/145 as well as for general use on uneven ceilings			138099

GEZE PERLAN FIXED PANEL

GEZE Perlan 140 fixed panel

The integrated GEZE Perlan 140 solution with fixed panel creates transparent and comfortable passage doors. The virtually invisible floor and side profiles create a continuous, consistent appearance and augment the generous feeling of space provided by the glass appearance. The installation could not be any easier. The fixed panels are securely held by rubber seals. No gluing is necessary. GEZE Perlan 140 with fixed panel is available as a complete 3 m profile set for independent assembly. All profiles and accessories can also be ordered individually.

GEZE Perlan 140 fixed panel



Application range

- For fully glazed connecting walls
- For all standard door widths
- For fixed panels up to 13 mm ESG or LSG
- Can be combined as a system with virtually all Perlan 140 components

Technical data

Product features	GEZE Perlan 140 fixed panel
Door material	Glass
Number of leaves	1-leaf, 2-leaf
Type of installation	Ceiling installation
Automated	•
Fixed panel	•
Draw-in damping	•

• = YES

Standard installation

Drawing No. 10421-ep50

Note

The door leaf must be stopped by a further angle buffer – in addition to the tube buffer. The buffer must be attached at mid door height.

Option: Glass clamping plate continuously covered!

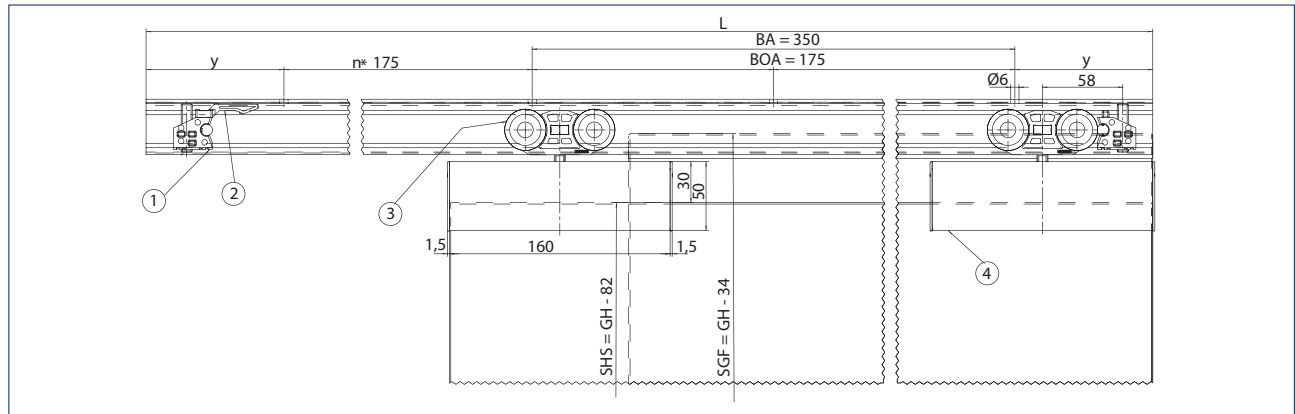

- 1 = Tube buffer
- 2 = Hold-open spring
- 3 = Double roller carriage
- 4 = Glass clamping plate
- L = Track length
- BA = Fixing spacing
- BOA = Drilled hole distance
- y = Distance end of track to centre of first drilled hole
- SHS = Panel height closing panel
- SHF = Panel height fixed panel
- GH = Total height
- n = Quantity

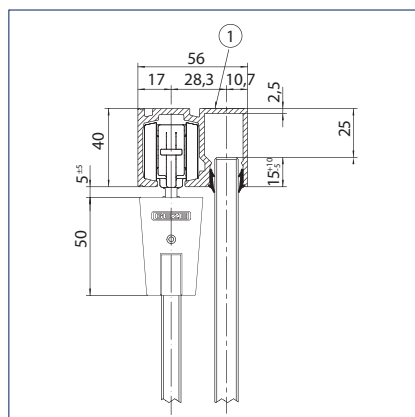

- 1 = Track for fixed panel

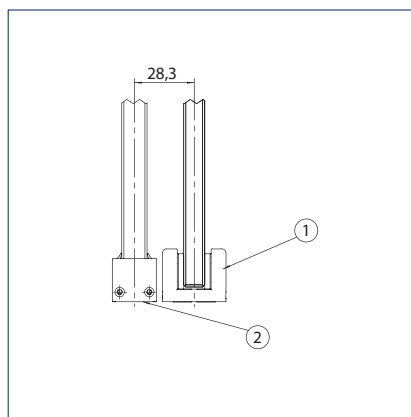

- 1 = Adjustable floor guide
- 2 = Cover cap for fixed panel

GEZE PERLAN FIXED PANEL

GEZE Perlan 140 fixed panel - Order information

Description	Length	Version	ID.No.
Perlan 140 track, fixed panel	3000 mm	EV1	126962
	6000 mm	EV1	126963
	6050 mm	stainless steel colour	128344
Perlan 140 track, fixed panel Customized		EV1	128077
		stainless steel colour	128345
Track Perlan 140 fixed panel with countersunk drill hole	6050 mm	EV1	128652
	6050 mm	stainless steel colour	128654
Track Perlan 140 fixed panel with countersunk drill hole Customized		EV1	128653
		stainless steel colour	128655
Perlan fixed panel set configured to customer wishes			128079
Perlan fixed panel set Profiles complete set consisting of: Perlan fixed panel track 3 m, 1.5 m cover profile, 4.5 m U profile, 12 m rubber seal		EV1	126995
Accessories			
Cover profile fixed panel for Perlan 140	1500 mm	EV1	127004
	6000 mm	EV1	127003
	6050 mm	stainless steel colour	128342
Cover profile fixed panel for Perlan 140		EV1	128078
		stainless steel colour	128343
U profile Perlan, Levolan fixed panel	1500 mm	EV1	126966
	3000 mm	EV1	126964
	6000 mm	EV1	126965
	6050 mm	stainless steel colour	128294
U profile Perlan / Levolan fixed panel Customized		EV1	128076
		stainless steel colour	128295
Glass seal for Perlan / Levolan fixed panel for 8 / 10 / 12 mm glass thickness	12000 mm	black	158650
	12000 mm	grey	126869
End cover set with 2 x glazing supports for use with U profile fixed panel on Perlan / Levolan systems		EV1	127001
		stainless steel colour	128361

GEZE Perlan 140 Duosync

The roller design fitting for synchronous opening and closing of 2-leaf doors

With the Perlan 140 Duosync, both leaves can be comfortably and conveniently opened and closed with only one move. This is achieved almost silently by precision ball bearings and the toothed belt connection. The complete system has a low overall height and yet is nevertheless stable and virtually maintenance free. If required the system can be concealed using the GEZE clip-on cover system. Duosync is available for both wooden and glass doors.

The accessories set includes 1 x toothed belt 12.5 m, 2 x deflection pulleys, 1 x belt coupler, 1 x adapter for wooden or glass leaves (depending on the set). Perlan 140 Duosync can be combined with any standard Perlan set.

GEZE Perlan 140 Duosync



Application range

- For wood, plastic, glass and metal leaves up to 140 kg leaf weight
- For large opening widths up to 2400 mm, special widths on request
- For leaf widths from 500 mm
- Compatible with virtually all Perlan 140 accessories

Technical data

Product features	GEZE Perlan 140 Duosync
Door material	Wood, Plastic, Metal, Glass, Sliding shutters
Leaf weight (max.)	140 kg
Opening width (max.)	2400 mm
Type of installation	Wall installation, Ceiling installation
Telescope	•
Fixed panel	•

• = YES

GEZE PERLAN 140 DUOSYNC

Standard installation

Drawing No. 10421-ep08

Note

The door leaf must be stopped by a further angle buffer – in addition to the tube buffer. The buffer must be attached at mid door height.

The wall recesses must be made accessible by a removable cover. We recommend dampening the main closing edge by using elastic buffers to be installed by the customer on site.

Mounting to a synchronous double-leaf sliding door with glass leaf and glass clamping plate

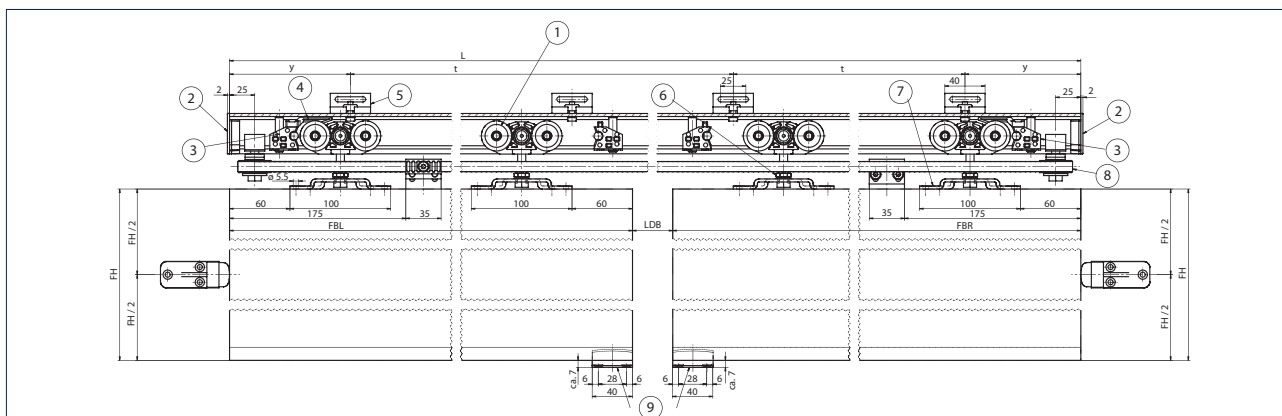

- 1 = Double roller carriage
- 2 = End cap (optional)
- 3 = Tube buffer
- 4 = Hold-open spring
- 5 = Wall attachment bracket Perlan 140
- 6 = Suspension bolt Perlan 140
- 7 = Carrier plate
- 8 = Duosync set
- 9 = Floor guide
- L = Track length
- y = Distance end of track to centre of first drilled hole
- t = Hole spacing
- FBL = Leaf width left-hand leaf
- LDB = Clear passage width
- FBR = Leaf width right-hand leaf
- FH = Leaf height

Can be fixed directly or with a plate on the ceiling or a bracket on the wall:

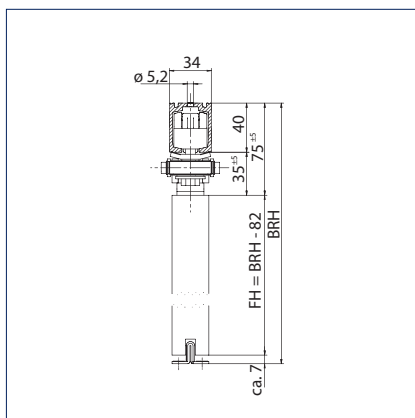

Direct ceiling mounting

FH = Leaf height

BRH = Overall height

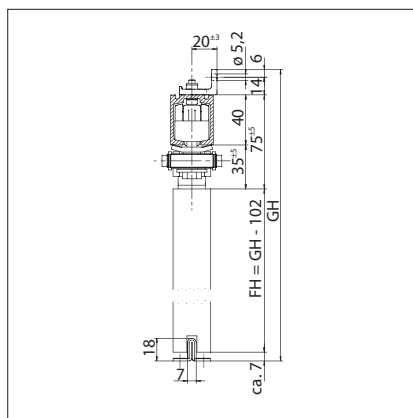

Wall mounting with angle

FH = Leaf height

GH = Total height

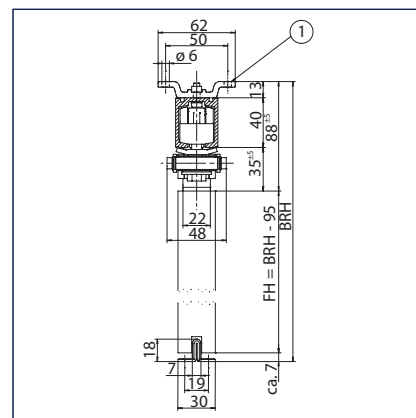

Ceiling installation with plate

1 = Ceiling attachment angle Perlan 140

FH = Leaf height

BRH = Overall height

Standard installation on glass leaves

Drawing No. 10421-ep09

Mounting to a synchronous double-leaf sliding door with glass leaf and glass clamping plate

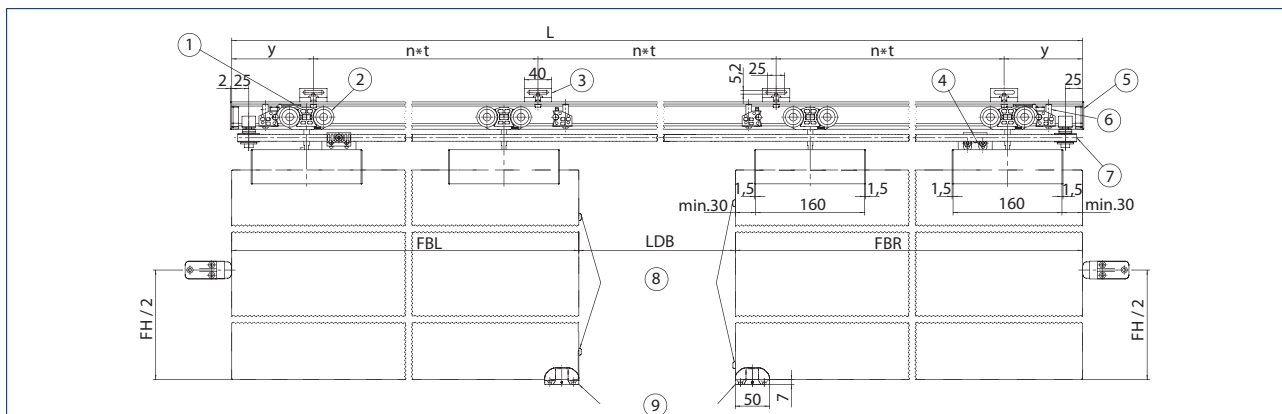

- 1 = Hold-open spring
- 2 = Double roller carriage
- 3 = Wall attachment bracket Perlan 140
- 4 = Duosync glass adapter
- 5 = Tube buffer
- 6 = End cap (optional)
- 7 = Duosync set
- 8 = Elastic buffer (on site)
- 9 = Adjustable floor guide
- L = Track length
- y = Distance end of track to centre of first drilled hole
- t = Hole spacing
- FBL = Leaf width left-hand leaf
- FBR = Leaf width right-hand leaf
- LDB = Clear passage width
- FH = Leaf height
- n = Quantity

The fitting can be fixed directly on the ceiling or fixed to the wall or ceiling using an angle bracket or plate:

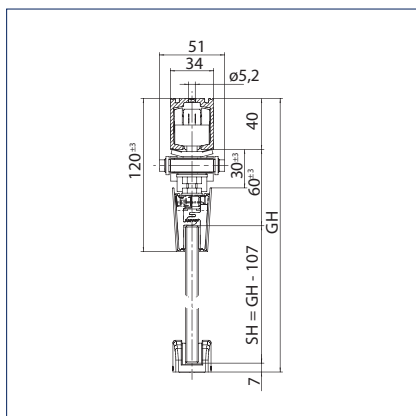

Direct ceiling mounting
SH = Panel height
GH = Total height

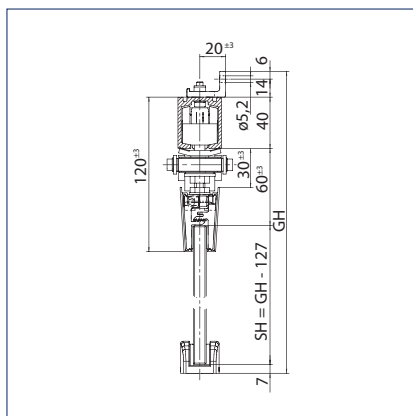

Wall mounting with angle
SH = Panel height
GH = Total height

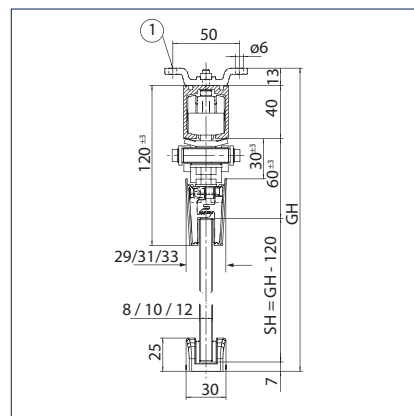

Ceiling installation with plate
GLS= Thickness of glass
SH = Panel height
GH = Total height
1 = Ceiling attachment angle Perlan 140

GEZE PERLAN 140 DUOSYNC

GEZE Perlan 140 Duosync - Order information

Description	ID.No.
Perlan Duosync 2 set for wooden leaves for the synchronisation of double-leaf doors up to 140 kg per leaf, comprising: 2 x return pulley, 2 x driver for wood, toothed belt 12.5 m, mounting material	139206
Perlan Duosync 2 set for glass leaves for the synchronisation of double-leaf doors up to 140 kg per leaf, comprising: 2 x return pulley, 2 x driver, glass clamping plate 45 mm, toothed belt 12.5 m, mounting material	139207
Accessories	
Driver glass clamping plate 30 mm for Perlan AUT NT / AUT 2 / Duosync 2, including 2 x extended suspension bolts	143295
Driver glass clamping plate 45 mm for Perlan AUT NT / AUT 2 / Duosync 2, including 2 x extended suspension bolts	134281
Driver wood for Perlan AUT NT / AUT 2 / Duosync 2, including 2 x extended hanger bolts	134280