

FEATURES AND BENEFITS

- various window functions, tailored to the needs of users
- possibility of bending profiles and building arched windows
- other aesthetic solutions provided by concealed sash windows, stylish steel look in Industrial version and glazing beads available in three versions: Standard, Prestige, Style
- 1- or 2-leaf doors opened inwards or outwards, including doors with the so-called "safe doorstep"
- designs adjusted to use various types of fittings including, but not limited to, window concealed hinges, door roll hinges
- basis for solutions with enhanced thermal insulation properties: MB-70 HI, MB-70US HI and MB-70CW HI
- possibility of building two-colour constructions: profiles can have different colours inside and outside

TECHNICAL SPECIFICATION	MB-70 MB-70 HI	MB-70US MB-70US HI	MB-70 Industrial MB-70 Industrial HI	MB-70SG	MB-70CW MB-70CW HI
Depth of Frame (door / window)	70 / 70		70		
Depth of Leaf (door / window)	70 / 79		79		
Glazing range mm (fixed window and door / opening window)	15 - 51 / 23 - 60	9 - 45 / 18 - 54	15 - 51 / 23 - 60	18 - 54	9 - 45 / 18 - 54
Min visible width T profile					
Door / window frame	51 / 47	75	47	47	78,5
Door / window leaf	72 / 32	-	32	-	34,6
Size and weight limitations					
Maximum size of window (HxW)	H 1100 mm W 1250 mm	H do 2100 mm W do 1400 mm	-	H 2400 mm W 2000 mm	-
Maximum size of door (HxW)	H 2400 mm W 1300 mm	-	-	-	-
Max weight of doors / windows	120 / 130 kg	130 kg	-	130 kg	-
Types of construction					
Available solutions	tilt window, turn window, tilt&turn window, doors open in and open out	fixed window, tilt window, turn window, tilt&turn window	fixed window, tilt&turn window	turn window, tilt window, tilt&turn window	fixed window, tilt&turn window

PERFORMANCE	MB-70 MB-70 HI	MB-70US MB-70US HI	MB-70 Industrial MB-70 Industrial HI	MB-70SG	MB-70CW MB-70CW HI
Air Permeability	Class 4, EN 1026:2001; EN 12207:2001				
Resistance to windload	Class C5 (2000Pa) EN 12211:2001; EN 12210:2001			Class C6 (>2000Pa) EN 12211:2001; EN 12210:2001	
Watertightness	Class E1200 (1200Pa) EN 1027:2001; EN 12208:2001			E750 (750Pa) EN 1027:2001; EN 12208:2001	
Thermal Insulation U_f W/(m ² K)	from 1,0	from 1,5	from 1,9	from 2,2	from 1,4



• U_f from 1,0 W/(m²K)

• Flexibility of design

• Secured by Design Accredited

Window and door system

MB-70

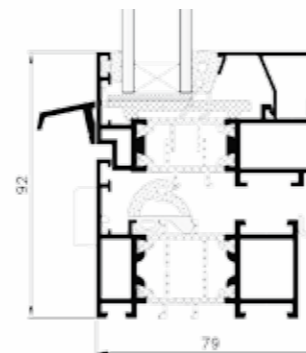

Opening window - cross section

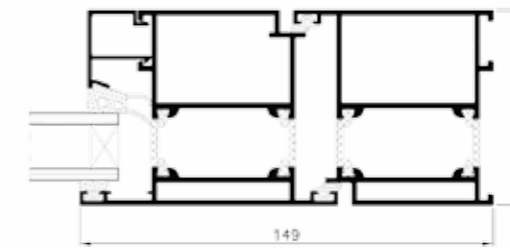

Door - cross-section



The Aluprof MB-70 is a high performance and fully integrated window and door system. Due to the specially designed polyamide break and extruded gaskets that are incorporated into the aluminum profile it offers excellent thermal insulation performance with the U_f rate from 1,0 W/(m²K) and reduced noise properties. All of our MB-70 window and door variations can be glazed into MB-SR50 effortlessly resulting in a fully functional facade perfect for any building requirement.

MB-70 / MB-70HI

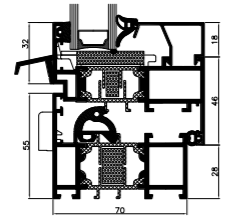

cross-section of MB-70HI window

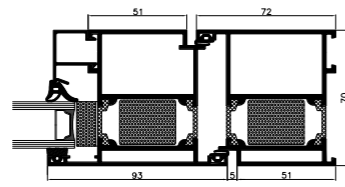

cross-section of MB-70HI door



The basic range of profiles allows the manufacturing of windows that open inwards and outwards. Thanks to its construction, it allows the use of many types of turn, tilt, turn-and-tilt and tilt-and-slide fittings as well as folding constructions. As regards doors, we have at our disposal the conventional single- or double-leaf doors as well as doors with the so-called safe doorstop. The system is also used for making bigger showcase structures using reinforcing profiles when required. It is also the basis for a number of interesting individual solutions.

MB-70US / MB-70US HI

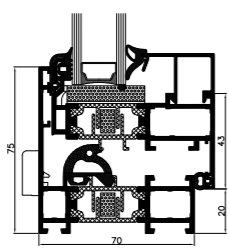

Opening window - cross-section

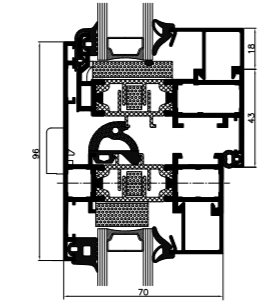

Opening window and fixed window - cross-section



The hidden sash variant of MB-70. It creates a seamless view from outside between fixed and opening sashes as per the drawings on the right. Available in both standard and the HI option for improved thermal performance.

MB-70 INDUSTRIAL / MB-70 INDUSTRIAL HI

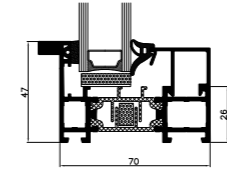

Fixed window - cross-section

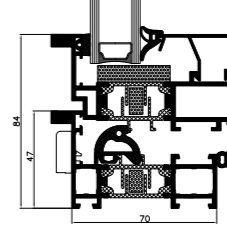

Opening window - cross-section



Whether for renovating old steel windows or giving a stylish steel look to new-build, the MB-70 Industrial enables to keep with the original style, providing all the benefits of modern aluminum technology. Combining attractive design options with long term reliability, the system also features enhanced thermal insulation properties to ensure energy conservation.

MB-70SG

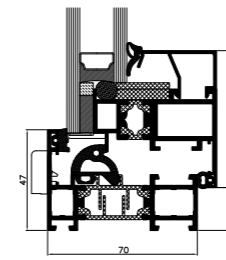

Opening window - cross-section

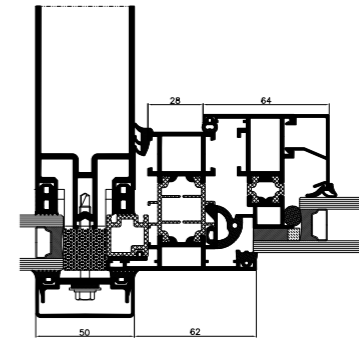

Active window in a curtain wall - cross-section



The MB-70SG system is a structural glazing system where the stepped unit is bonded back to the vent. This results in a frameless vent appearance externally.

MB-70CW / MB-70CW HI

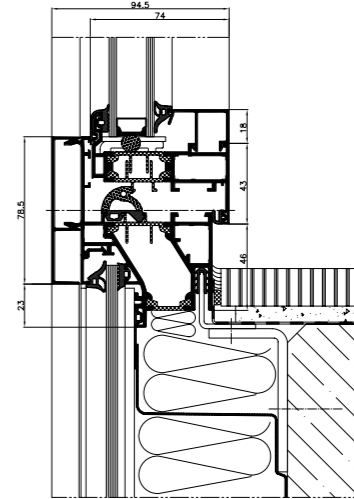

Cross-section of an active window



The variety of window that applies where there is curtain walls made up from either reinforced concrete or masonry. It features warm and cold zones with combination of high thermal insulation and in between window strips. Helps reduce fabricating and assembly time. Available in regular and enhanced thermal insulation versions.

WINDOW DIAGRAMS	SECTION A OR B	U _w [W/m ² K]		
		Glass pane with Thermix frame		
		Double-chamber		Single-chamber
		U _g =0,5	U _g =0,7	U _g =1,1
	 K518101X	0,83	1,00	1,35
	 K518101X + K518111X	1,02	1,17	1,48
	 K518101X + K518112X	0,80	0,97	1,32
	 K518102X + K518112X	0,98	1,13	1,44